

# Manual Maxidoor<sup>®</sup>

ENG

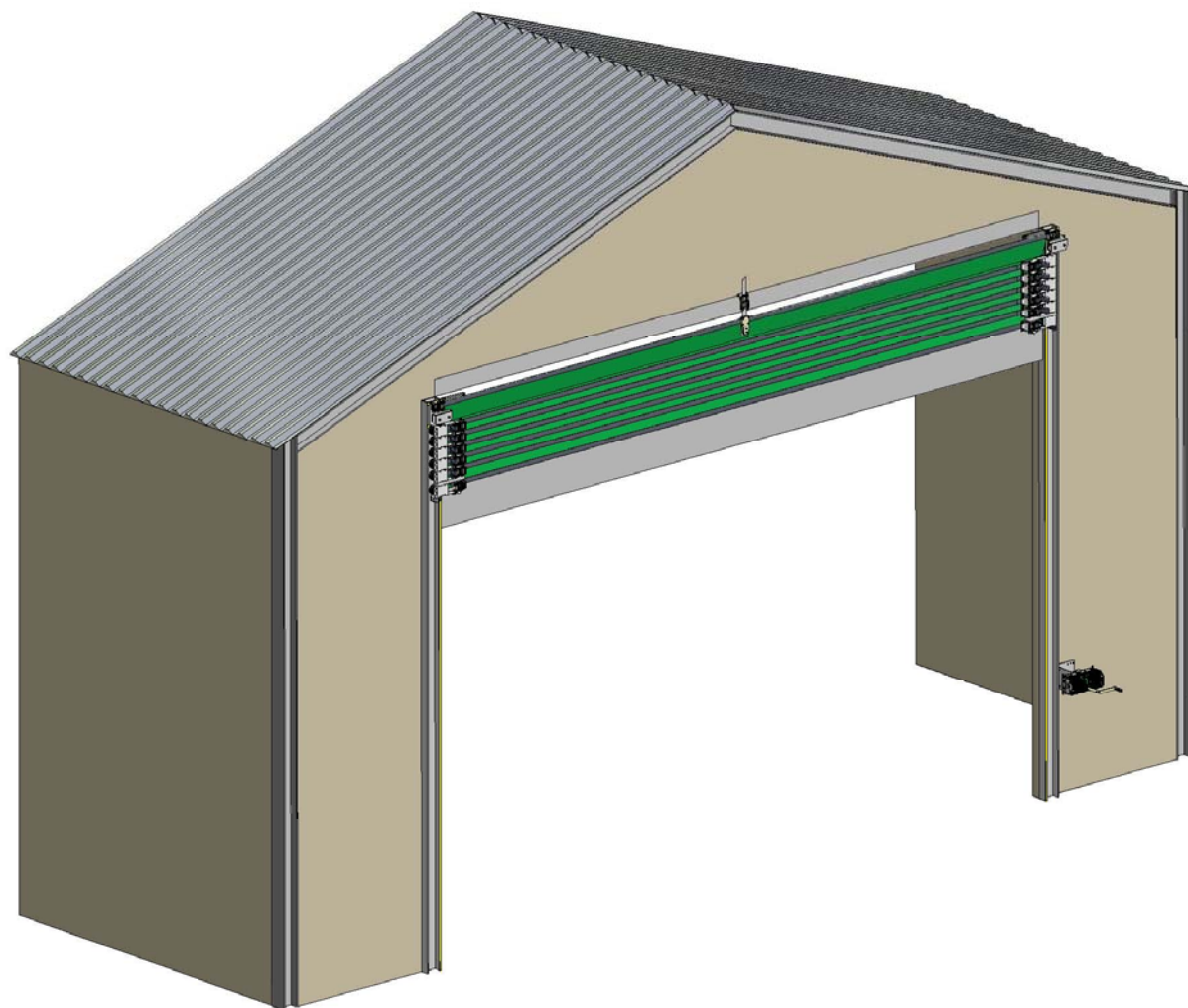

## Pre-Installation Instructions

***Galebreaker<sup>®</sup>***  
— AGRI —

1. Doors are manufactured to suit the opening, when ordering please supply Width A and Height B. Table 1 gives the access heights. The manual drive can be fitted to either side, please state preference when ordering. If preference not stated a right-hand drive (as shown in these instructions) will be supplied. Product overview is shown in Figure 1a.

ENG

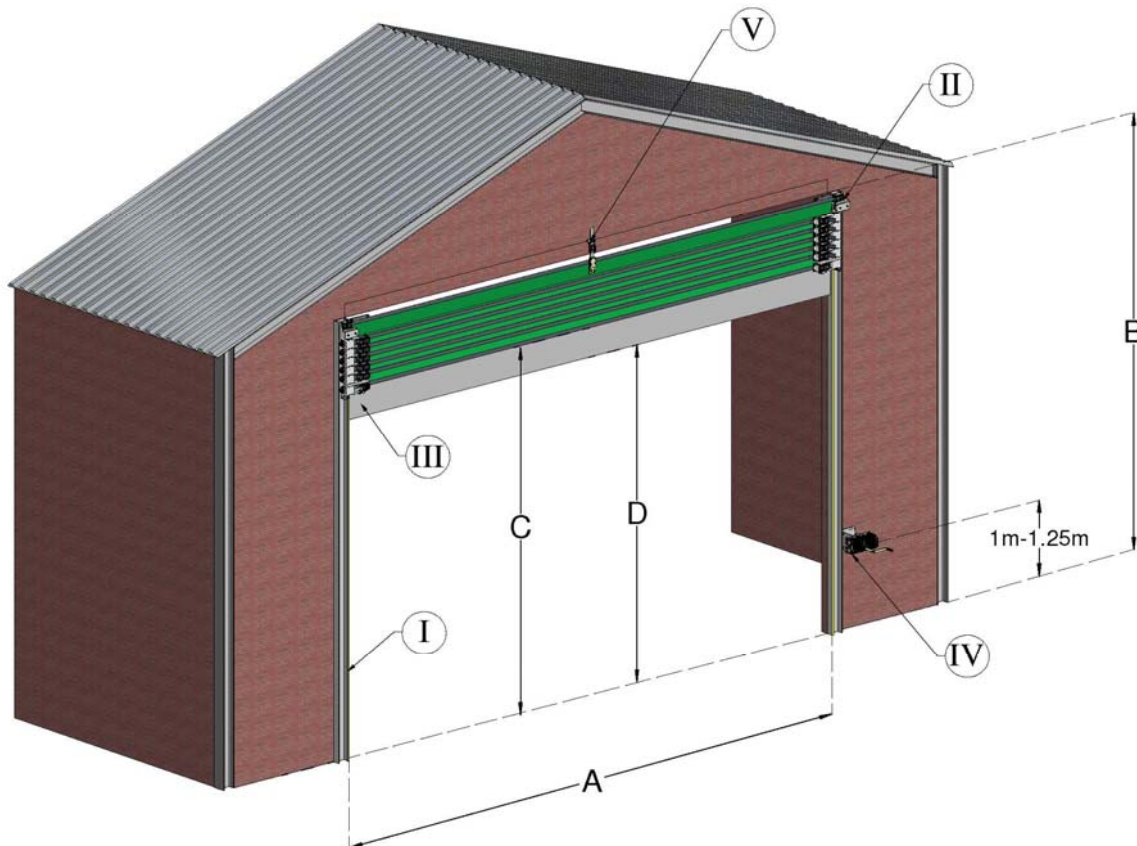

Figure 1a

Table 1: Access Height

DOOR HEIGHT (M)	HEIGHT TO BOTTOM STRAP (M)	CLEAR OPENING HEIGHT (M)
B	C	D
3.1	2.485	2.035
4.1	3.365	2.915
5.1	4.245	3.795
6.1	5.125	4.675
7.1	6.005	5.555
8.1	6.885	6.435
9.1	7.765	7.315
10.1	8.645	8.195



**CAUTION:** To safeguard against any danger points, the minimum height 'H' of any door is 3.2m.

In the event of power or door failure, the door must not form the only means of exit from the building to which it is fitted.

ENG

### Wind Loadings

The structure to which the door is fitted needs to be of adequate strength to resist the following wind loads.

Wind Speed (km/hr)	Wind Load (N)*	Wind Load (Kg)*
70 km/hr	= W x H x 233	= W x H x 24
100 km/hr	= W x H x 481	= W x H x 49
140km/hr	= W x H x 933	= W x H x 95

*\*No allowance made for safety margins*

Doors are designed to the following tolerances, Figure 1b refers:

Width  $A_T = A_B - 0\text{mm} / +20\text{mm}$ .  $A_T$  can be in the range of 0mm to 20mm wider than  $A_B$ , but must not be smaller.

Height  $B = - 50\text{mm} / + 100\text{mm}$ . Changes in floor level to be between 50mm narrower to 100mm taller.

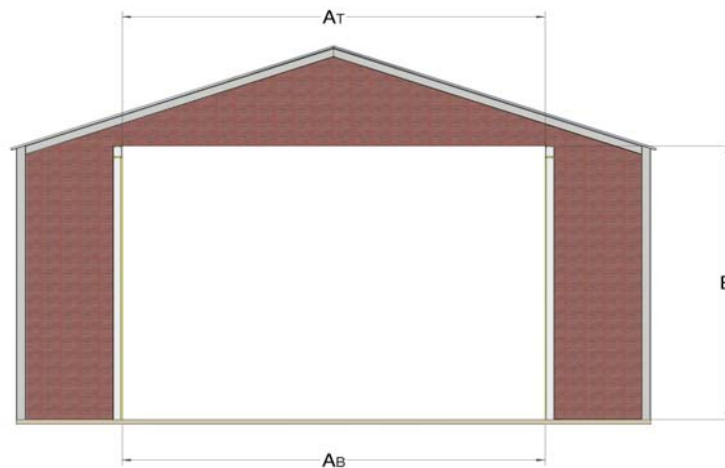
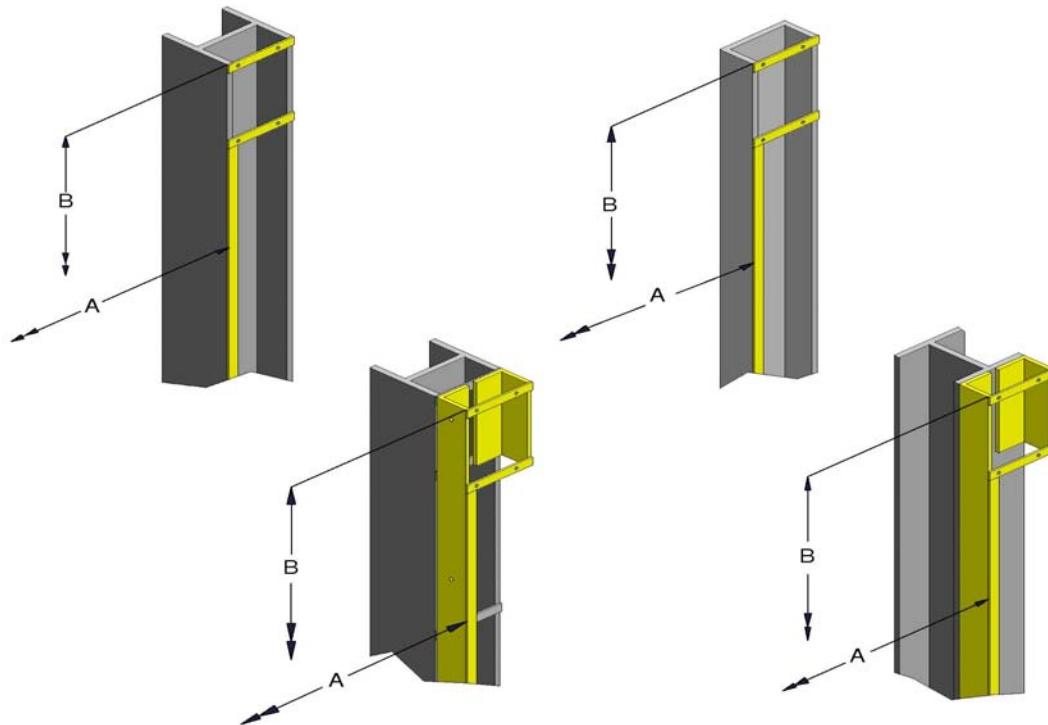

Figure 1b

3. Figure 2 and 3a indicates the recommended layouts and size of tracking. Ensure tracking is securely fixed to the building and/or ground. It is important that the track is installed vertically, the two sections are parallel, and that the tops are level. If you require further guidance on suggested size of track then contact Head Office



*Figure 2*

3. When fixing the trolley retaining lip onto the tracking, we recommend a 25mm weld every 250mm, continuous welding will generate too much heat and cause the tracking to twist.



Do not weld on the inner face of the tracking as this will obstruct the trolley wheel, see Figure 3b

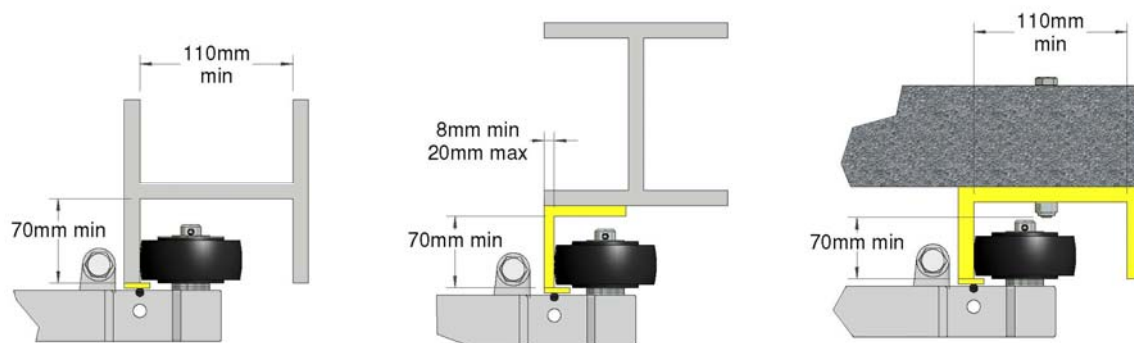

Figure 3a

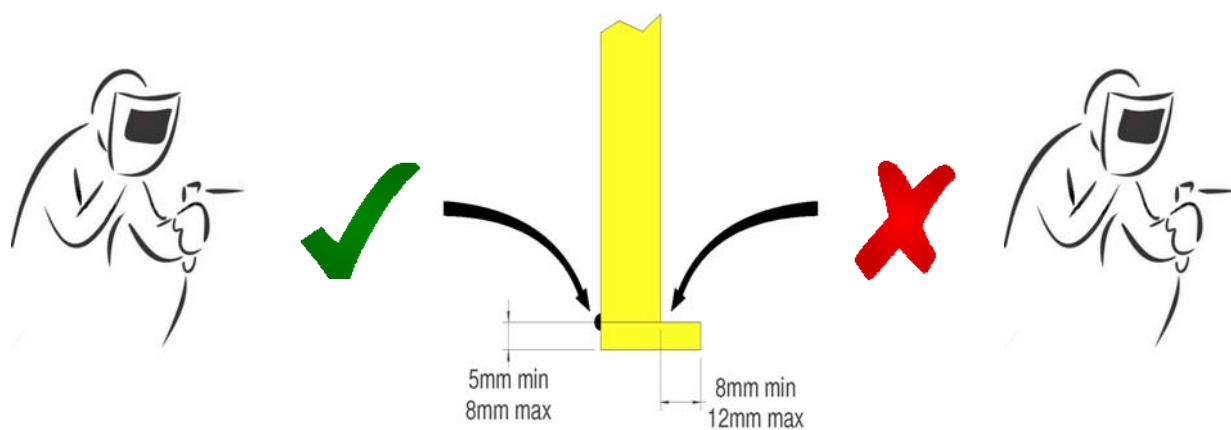
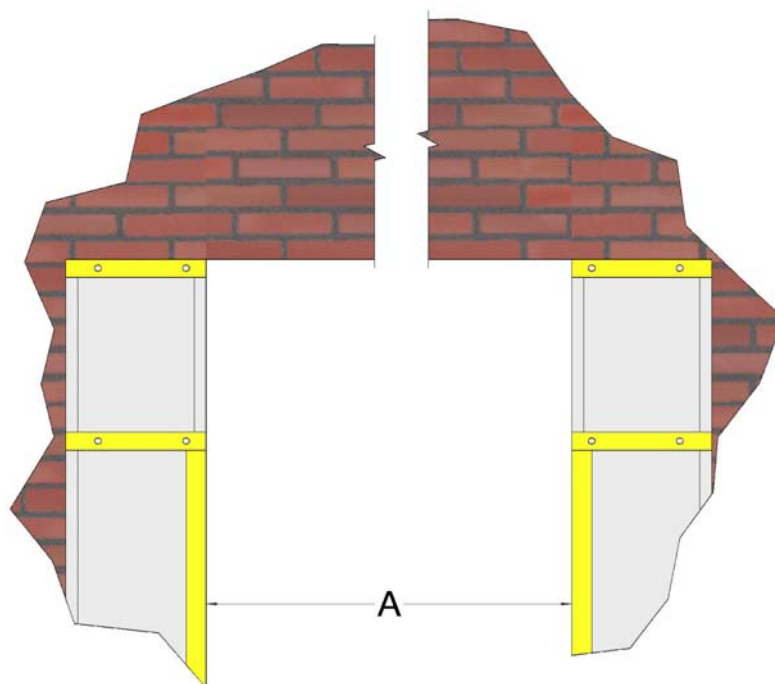
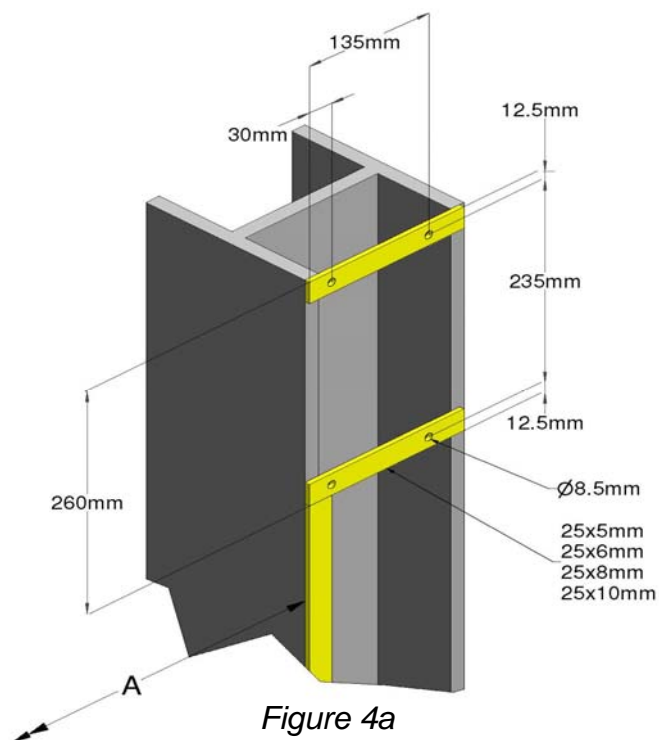

Figure 3b

4. The position and size of the top fixing brackets are shown in Figure 4a and 4b; the four holes retain the top pulley and ratchet plate.



5. There must be a minimum of 300mm clearance either side of the tracking to provide sufficient space for the door panel to fold and to prevent damage by abrasion, see Figure 5. Check that there are no obstructions (gutters, downpipes, etc.) to hinder the operation of the door.

ENG

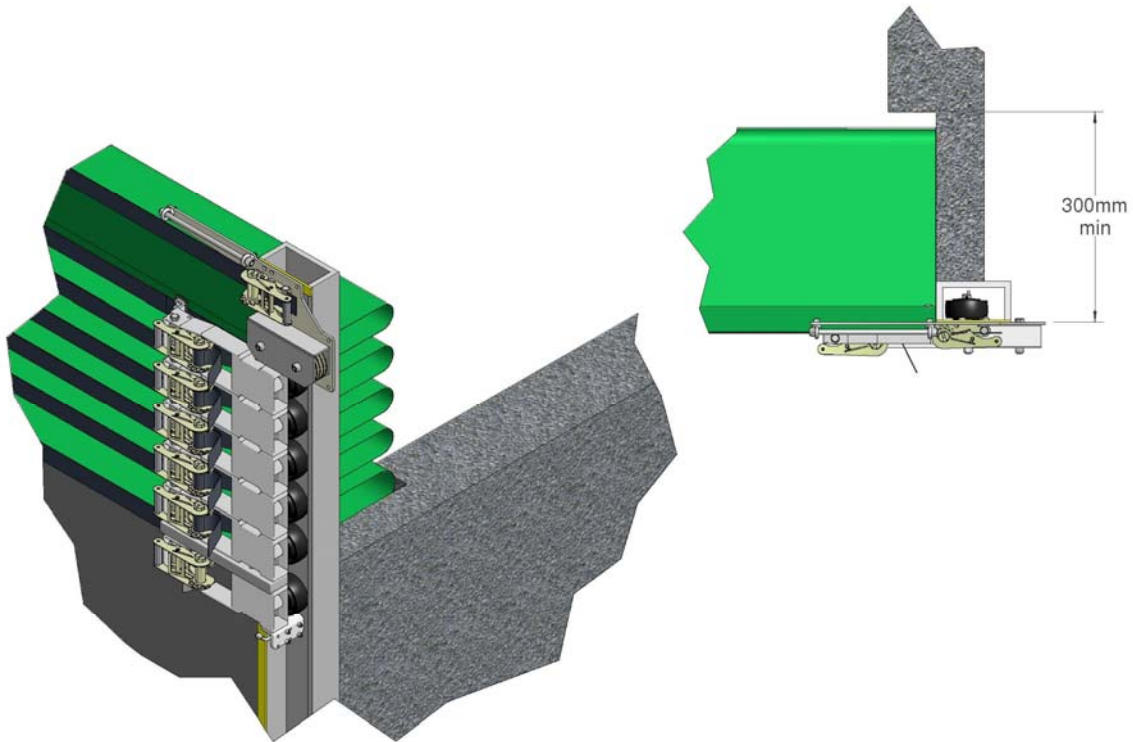

Figure 5

6. Figure 6 indicates the position of the manual drive and the space required for its operation. The drive must be vertical and its centre needs to align with the exit point of the lifting cable from the top bracket.

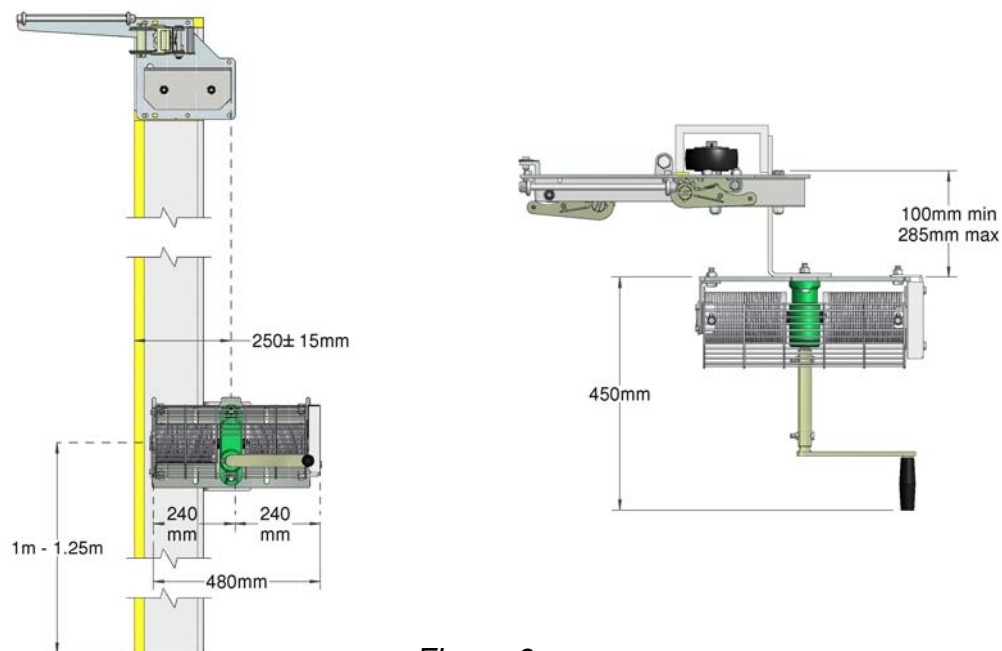

Figure 6

7. Figure 7 shows the various fitting possibilities for the manual drive using the two mounting brackets supplied with the door. Ensure the fixing surface can withstand the maximum door weight of 350Kg.

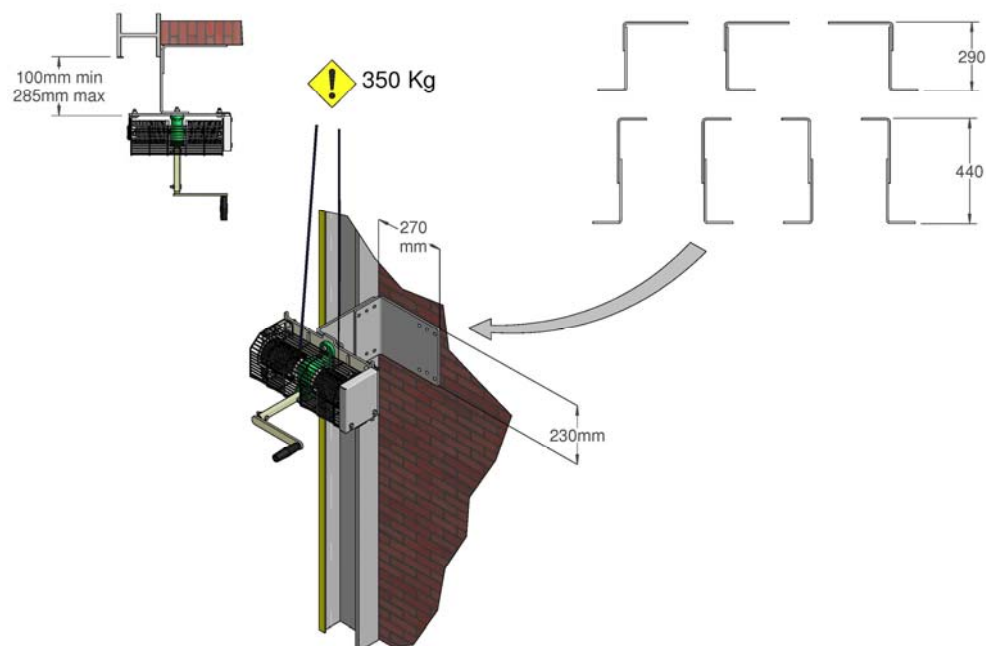

Figure 7



8. Lifting Cable and Panel Support: Additional support(s) for the panel and lifting cable is supplied for doors over 10m wide in accordance with Table 2. See Figures 8a and 8b. The inset drawing shows the footprint of the fixing bracket is 120 x 60mm.

Table 2: Quantity of Supports

DOOR WIDTH (A)	QUANTITY
0M -> 9.9M	0
10M -> 14.9M	1
15M -> 20M	2

ENG

8.1 Width 10m -> 14.9m: One Support

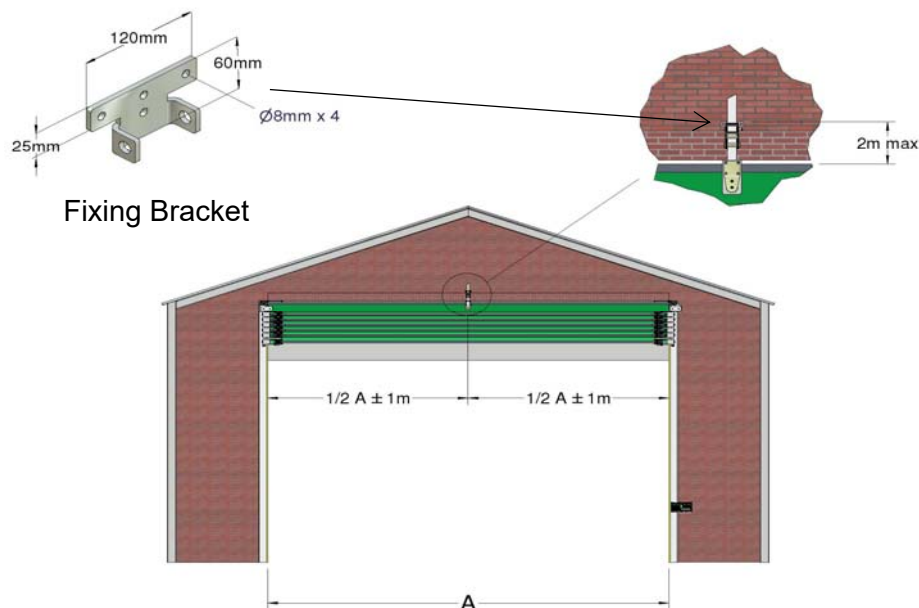

8.2 Width 15m -> 20m: Two Supports

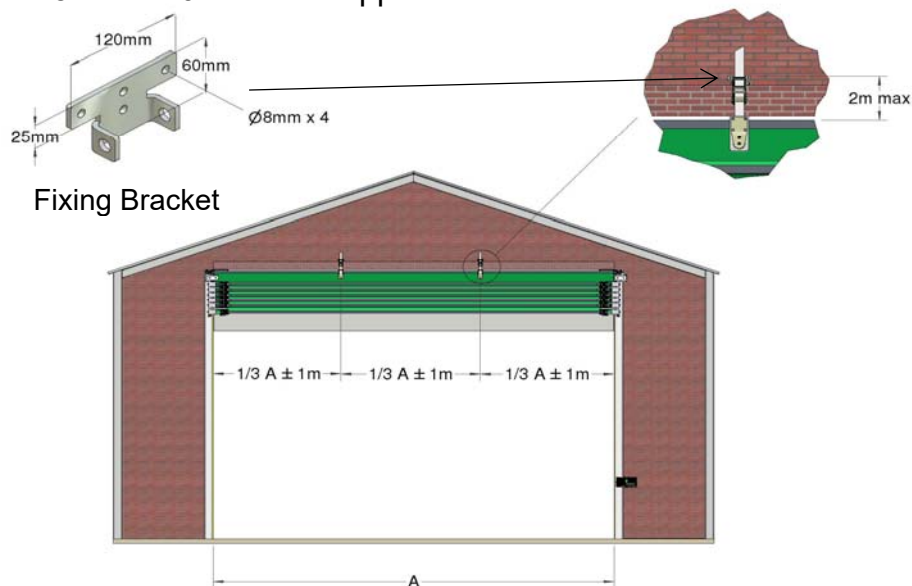

9. Figures 9a through to 9c show three manual drive fitting locations for adjacent doors.

- ❖ If the two drives can be positioned on extreme left and right then the minimum width of the central tracking is 250mm (Figure 9a).
- ❖ If one of the drives is to be mounted to the central column then the minimum width of the central column is 500mm (Figure 9b).
- ❖ If both drives are to be mounted on extreme left or right then the minimum width of the central tracking is 250mm, and 1000mm is required to accommodate the adjacent drives (Figure 9c). If this option is required contact your Galebreaker Dealers, Distributor or Head Office for details of the additional parts.

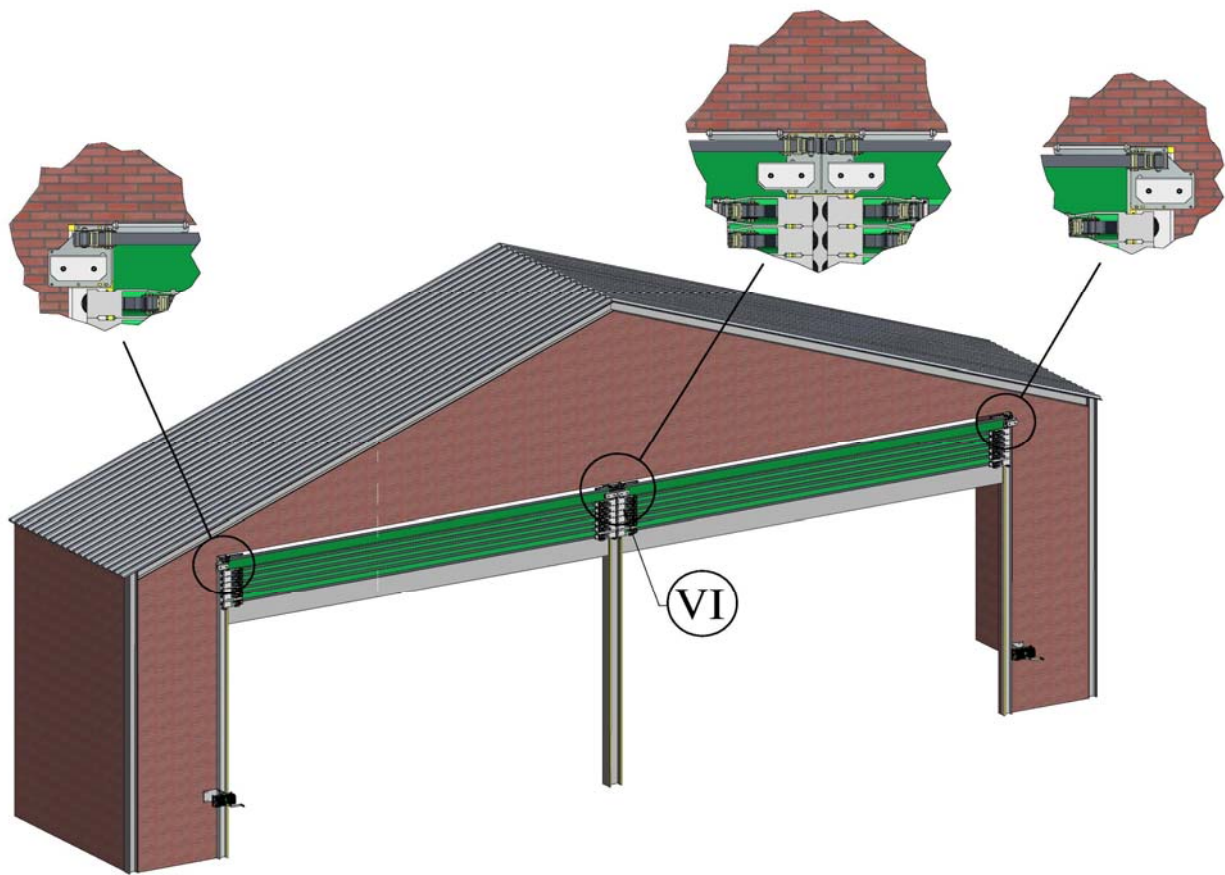

*Figure 9a. Drives on left and right*

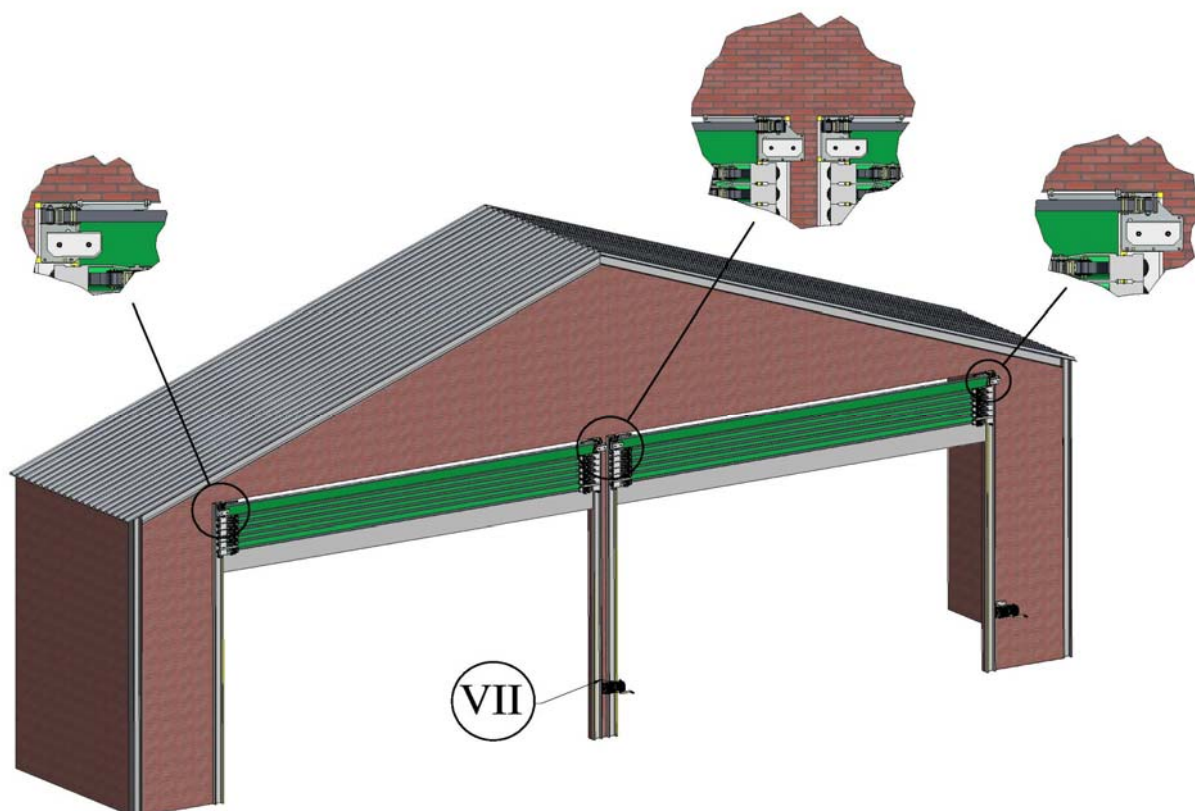

Figure 9b. One centrally mounted drive

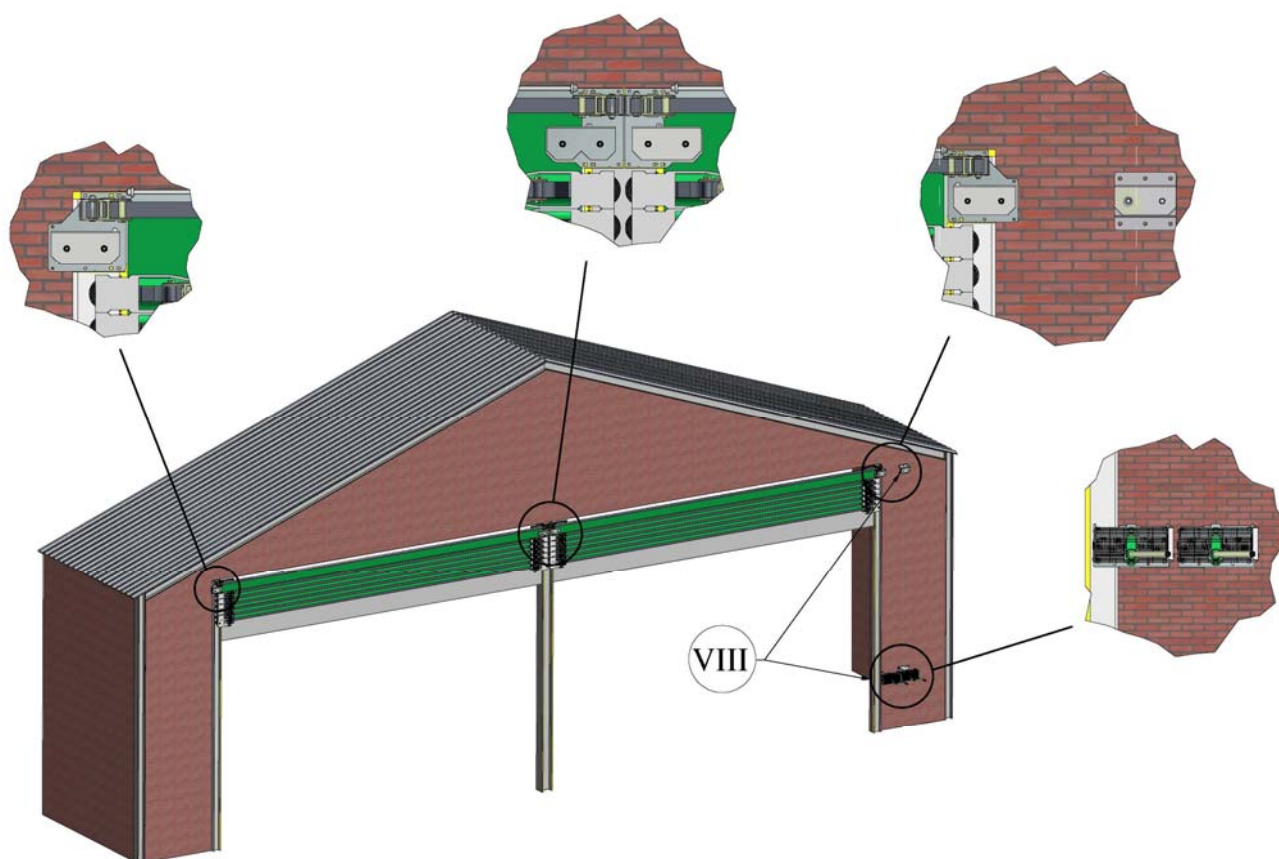

Figure 9c. Adjacent drives

10. Central tracking without drives: Detail of the central tracking is shown in Figure 10. The majority of the tracking details are the same as Area I. Of particular note:

- ❖ Minimum tracking width of 250mm.
- ❖ Position and size of the top fixing brackets and the eight holes to retain the adjacent top pulley and ratchet plate.
- ❖ Retaining lip to both sides of the tracking

ENG

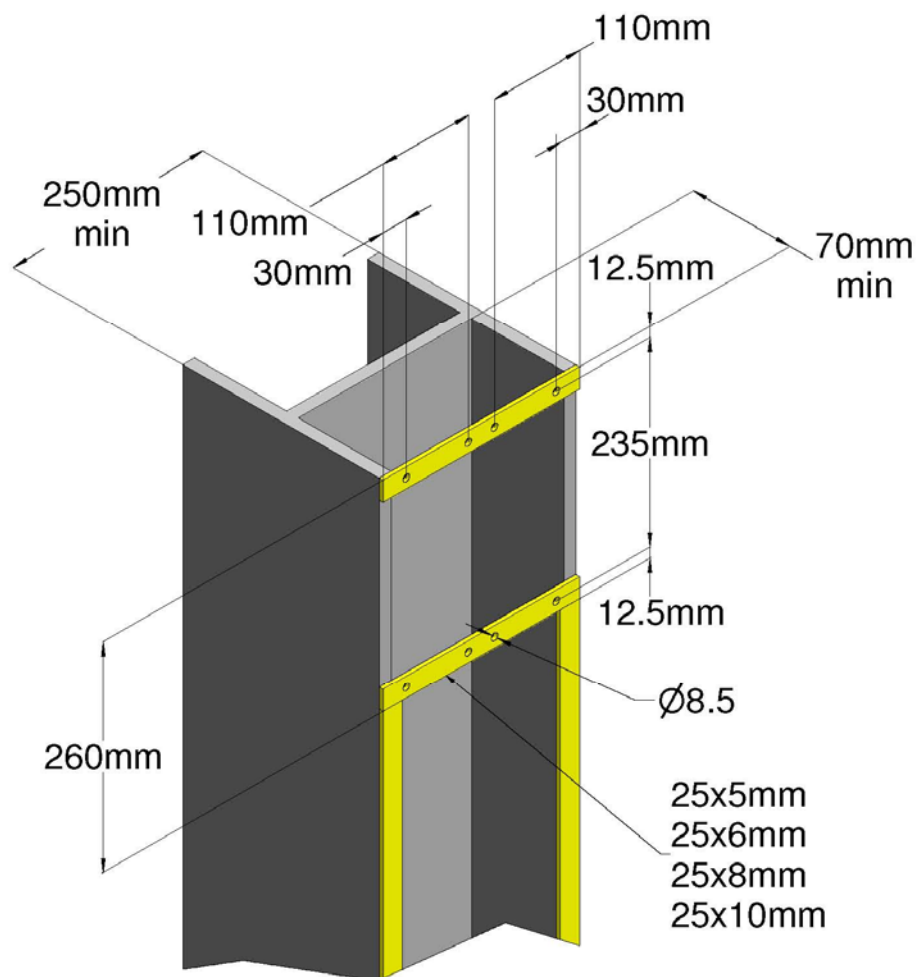

Figure 10

11. One drive centrally positioned: Suggestion for the central column based on two individual tracks is shown in Figure 11. Each tracking is independent and details are the same as Area I. Of particular note is the minimum column width of 500mm to prevent the manual drive impacting on the clear width of the opening

ENG

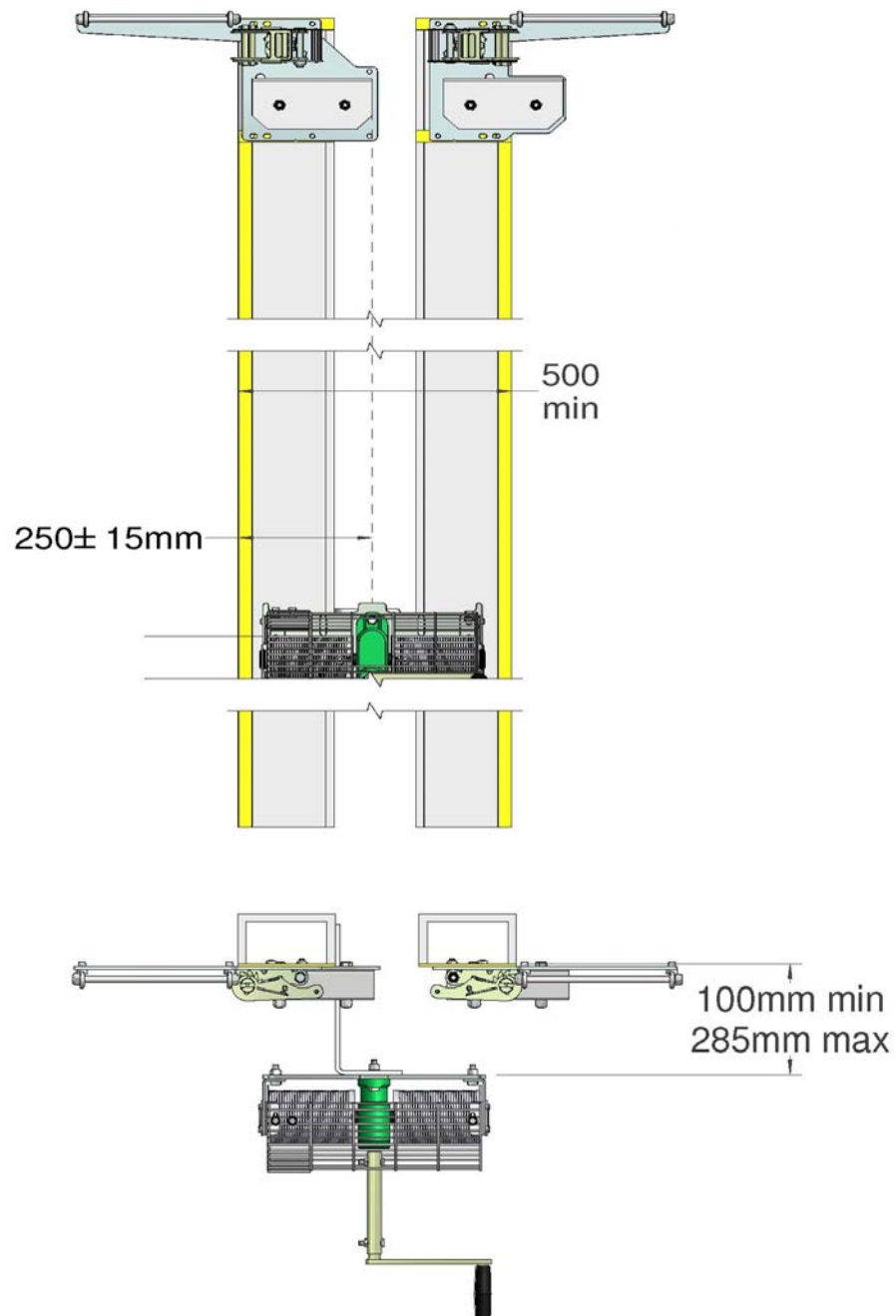

Figure 11

## 12. Adjacent Drives:

12.1 Central Tracking: Follow the details outlined in Point 10 above, minimum width of 250mm

12.2 Drives: Suggestion of layout is shown in Figure 12, Note that:

- ❖ Minimum width to accommodate both drives is 1000mm
- ❖ Both drives must be vertical and its centre needs to align with the exit point of the lifting cable from the top bracket / corner pulley.
- ❖ The fixing face for the corner pulley must align with the outside edge of the tracking.
- ❖ The corner pulley will be mounted at the same level as the top bracket.

ENG

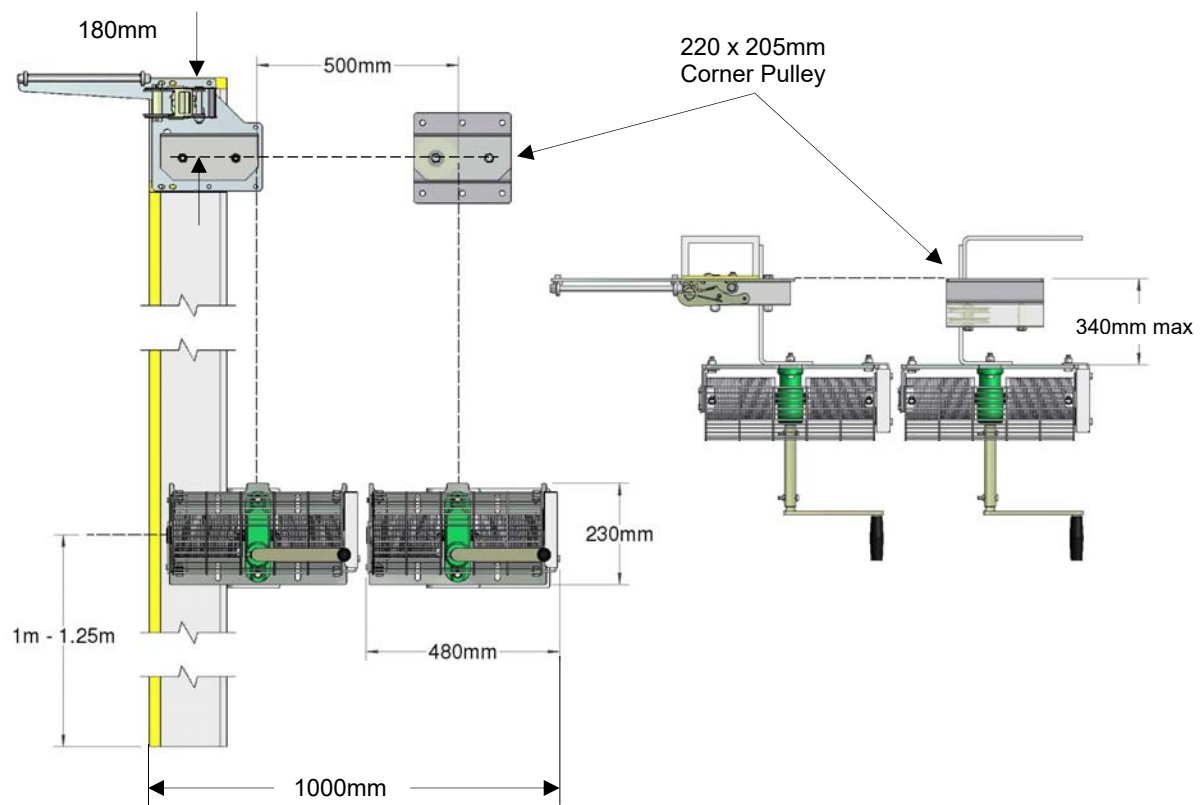

Figure 12



13. To increase the clearance height of the door the tracking can be extended above the opening.

13.1 Extensions up to 400mm: To prevent abrasion damaging the door panel, protection needs to be placed between the building and the fabric. Head Office can supply a Galebreaker® Pelmet for this function (see Area X for details), otherwise fix soft material such as PVC strip or Rubber strip to the building.

13.2 Extensions above 400mm: In addition to panel protection as detailed above, ensure there is 300mm clearance either side of the tracking to allow the door panel to fold (Figure 13a).

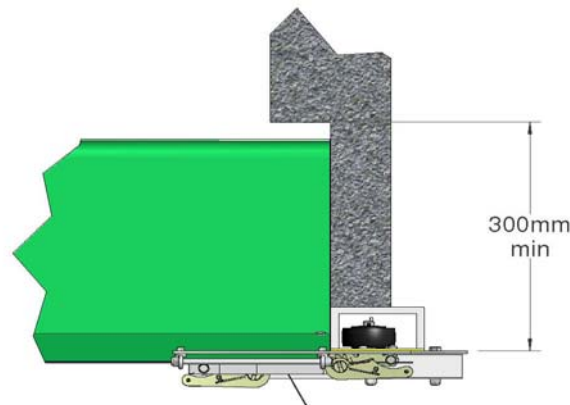

Figure 13a

13.3 Cantilever tracking extensions above the building (Figure 13b):  
Contact Head Office for further advice

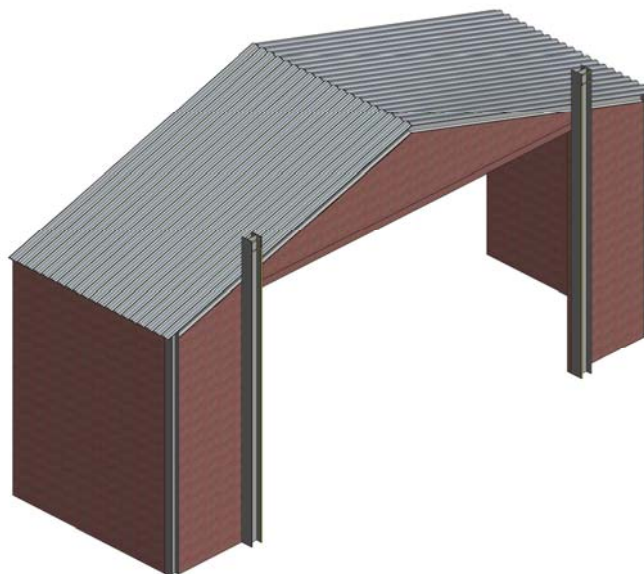

Figure 13b

14. Galebreaker® Pelmet: If required it is fixed along the full width of the opening between the top of the tracking and the bottom edge of the cladding. The Pelmet material is secured in place with a 45mm high Aluminium profile along the top and bottom (Figure 14). This profile needs to be placed on a level surface with fixings at a maximum distance of 1m, ensure the building face conforms to these requirements

**When ordering please supply height P as shown on Figure 14.** Note that:

- ❖ The 100mm overlap below the bottom edge of the cladding will be included during manufacture. The required dimension P is simply the vertical height from the top of the tracking to the bottom of the cladding.
- ❖ If the Pelmet material is not available in the same colour as the door, Grey will be supplied.

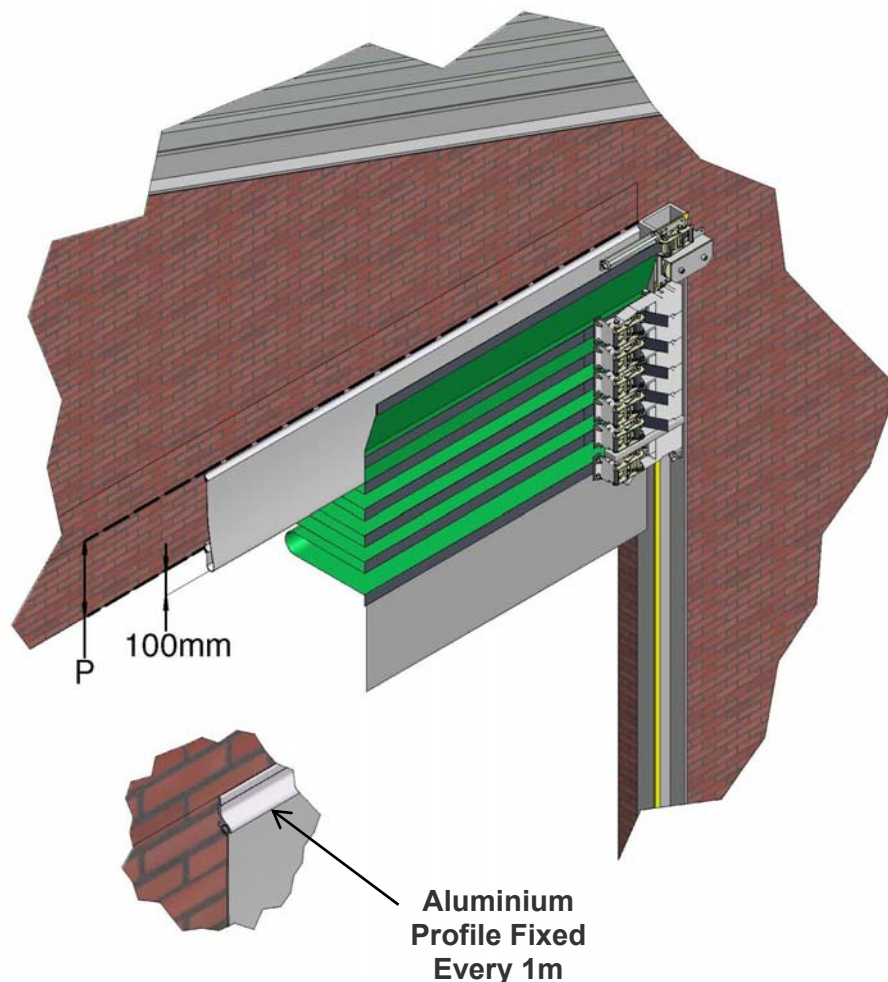

Figure 14



### 15. Fastenings

- ❖ Eight M8 x 30 Bolts are supplied to secure the top brackets to the tracking.
- ❖ Four M10 x 50 Bolts are supplied to secure the drive mounting plate to a metal surface up to 30mm thick (i.e. Plate, Channel, Universal Beam, Universal Column, etc.). Customer needs to supply own fastenings if securing to wood or concrete.

ENG

**NOTE: This product has been tested to European Standard EN 12424 with a Resistance to Wind Load rating of Class 5. Tried and tested in the harshest weather conditions, a summary of our guarantee is listed below, see our website for full details:**

- **Mechanical components: 100% guarantee for two years, followed by an eight year graduated guarantee.**

### **RAIN INGRESS:**

**Please note that in extreme weather conditions some moisture will penetrate a mesh material.**

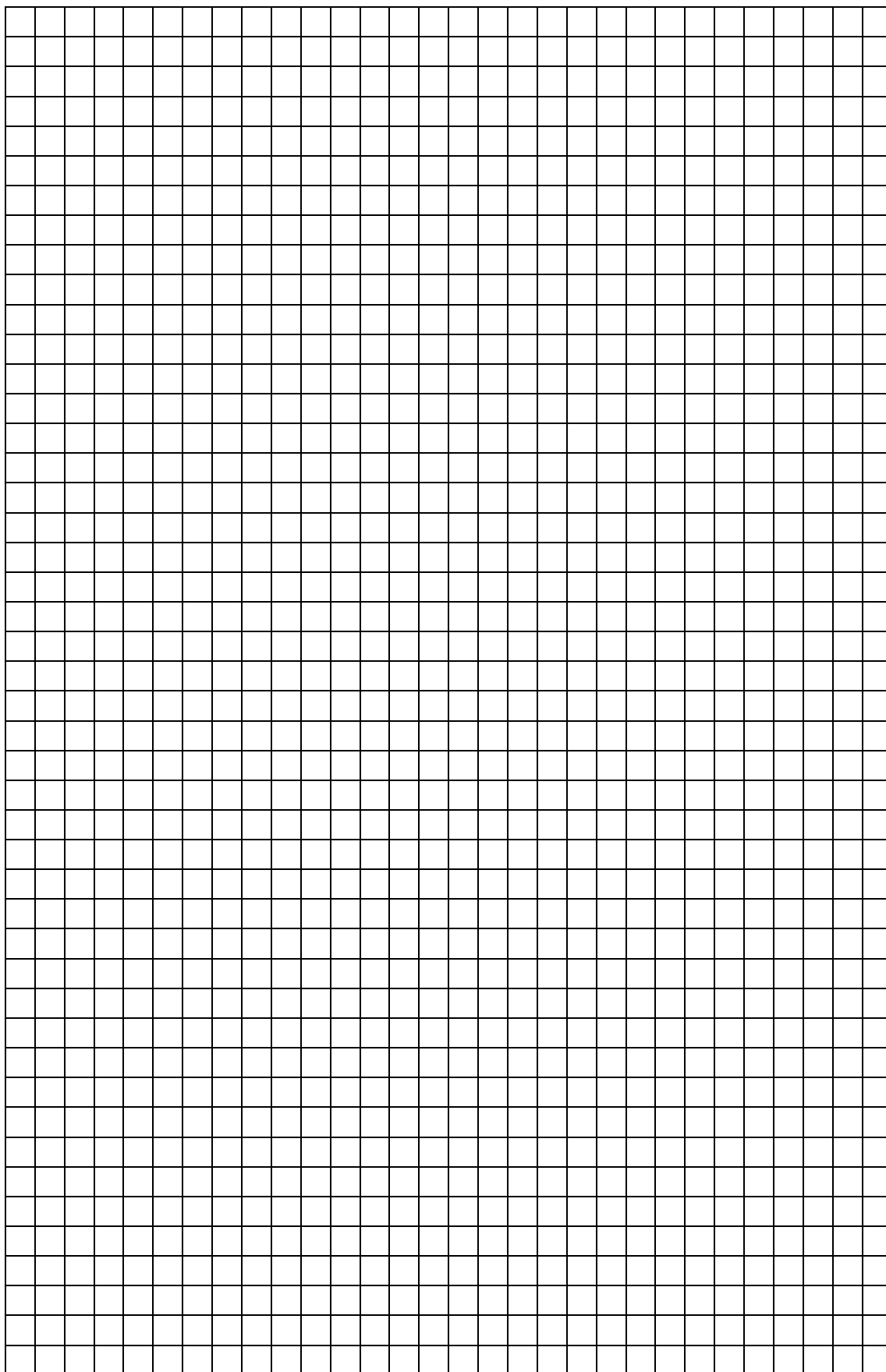

ENG



<b>Manufacturer:</b>	Galebreaker Agri Ltd.	<b>Tel:</b>	+44 (0) 1531 637 900
	Galebreaker House	<b>Fax:</b>	+44 (0) 1531 637 901
	New Mills Industrial Estate		
	Ledbury		
	Herefordshire, UK		
	HR8 2SS		

**[www.galebreaker.com](http://www.galebreaker.com)**

Designed and Manufactured in the UK by Galebreaker Agri Ltd.

Original Instructions

© Copyright Galebreaker Agri Ltd 2021. All Rights reserved

Model No: MD/MK5/0210

Instruction Ver: 2021/01/ENG

European Authorised Representative:

Authorised Representative Service, 77 Camden Street Lower, Dublin, D02 XE80, Ireland